

Stop 741 Door Knob  
Diameter 60mm  
Projection 66mm

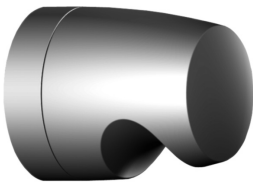

Stop 742 Door Knob  
Diameter 50mm  
Projection 63mm

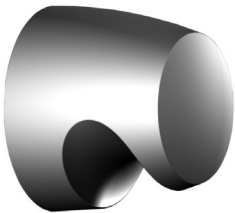

Stop 745 Dummy Trim  
Diameter 60mm  
Projection 63mm

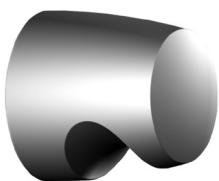

Stop 746 Dummy Trim  
Diameter 50mm  
Projection 50mm

## Stop Knobs

A contemporary and versatile range of door and cabinet knobs suitable for use throughout a project and across a number of applications. The unique sculptured form is available in all finishes.

### Features

- Finger-recess with a soft contour for user comfort
- Internal spring mechanism ensures positive latch and knob return
- Large bearing surface provides support for the solid knob machined from brass or bronze
- Suitable for long back set tubular latches and mortise locks with 38 or 44mm fixing centres
- Knobs are reversible to aid handing and can be turned 90 degrees on the base rose to provide vertical fixing with tubular latches, or horizontal fixing on mortise locks
- Knob fastens to the boss by a socket set-screw on the underside. Removal of the knob allows for tie-screw fixing through the door
- This range of door knobs is complemented by the 'Facet' range of escutcheons 3410 to 3414 in the Accessories Section

## Fixing Centres and Latch/Lock Types

### Stop 741 Door Knob

#### Fixing Centres:

38mm horizontal and vertical and 50.8mm @ 45 degrees

#### Lock/Latch Types:

- chant™ mortise locks
- Legge 990 MF Series and Lockwood 3500 Series mortise locks
- Profile cylinder mortise locks with nominal 38mm centres and light return springs
- Tubular latches – 60mm minimum backset

### Stop 742 Door Knob

#### Fixing Centres:

38mm horizontal and vertical

#### Lock/Latch Types:

- chant™ mortise locks
- Legge 990 MF Series mortise locks
- Profile cylinder mortise locks with nominal 38mm centres and light return springs
- Tubular latches – 60mm minimum backset

### Stop 745/746 Dummy Trim

A flanged mounting collar is fastened to the door with two screws, the knob attached to the mounting collar with a socket set-screw on the underside.

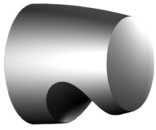

Stop 751 Cabinet Knob  
 Diameter 35mm  
 Projection 35mm  
 Fixing Screw M5

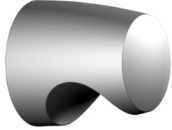

Stop 751b Cabinet Knob  
 Diameter 35mm  
 Projection 38mm  
 For use with 751 Cabinet Knob on the opposite side of the door. The 751 Knob is fastened to the door with a mounting collar then the 751b Knob is fastened to the collar in the correct alignment. Particularly suitable for shower doors.

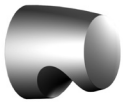

Stop 752 Cabinet Knob  
 Diameter 28mm  
 Projection 30mm  
 Fixing Screw M5



Stop 753 Cabinet Knob  
 Diameter 22mm  
 Projection 25mm  
 Fixing Screw M5

## Specifying

To specify (example)

Knob	Finish	Quantity
742	SCPV	2pr

It is recommended that the lock type is stated when ordering knobsets.

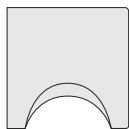
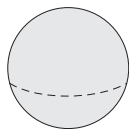
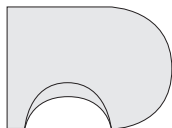
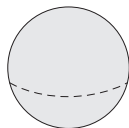
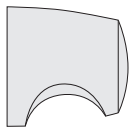
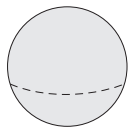

## Cross Section of Stop Knobs Showing Contoured Finger Recess

A unique detail of these knobs is that the finger recess is machined in a curved path. This softens the edge at each end providing a comfortable grip. This detail can be applied to custom made knobs of a cylindrical style with a flat or radius end. Contact chant™ to discuss your requirements.

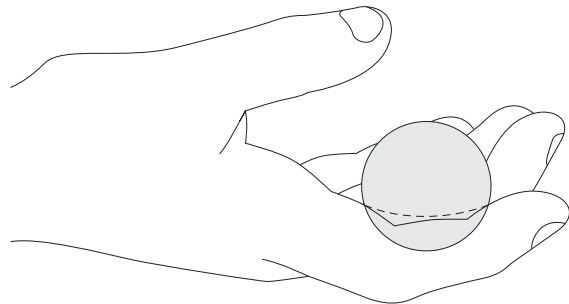

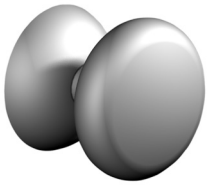

Round 761 on Mason 'A' Rose  
 Knob Diameter 70mm  
 Rose Diameter 63mm  
 Projection 65mm

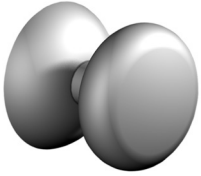

Round 762 on Mason 'A' Rose  
 Knob Diameter 63mm  
 Rose Diameter 63mm  
 Projection 64mm

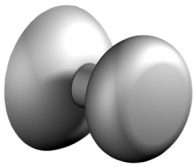

Round 763 on Mason 'A' Rose  
 Knob Diameter 55mm  
 Rose Diameter 63mm  
 Projection 64mm

Round 762, 763, 764 are available on the following chant™ Rose types:

38F, 38R, 38S or  
 41F, 41R, 41S  
 F=Facet, R=Radius, S=Square

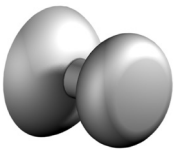

Round 764 on Mason 'I',  
 'J' and 'K' Rose  
 Knob Diameter 50mm  
 Rose Diameter 57mm  
 Projection 60mm

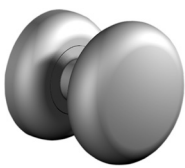

Round 762 on chant™ 38R Rose  
 Knob Diameter 63mm  
 Rose Diameter 57mm  
 Projection 64mm

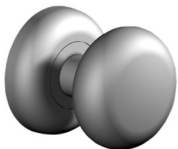

Round 763 on chant™ 38R Rose  
 Knob Diameter 55mm  
 Rose Diameter 57mm  
 Projection 62mm

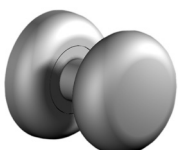

Round 764 on chant™ 38R Rose  
 Knob Diameter 50mm  
 Rose Diameter 57mm  
 Projection 60mm

## Round/Royal Knobs on Rose

Round door knobs and matching escutcheons are designed for front doors and applications where a circular knob is required. This simple, elegant design can be used with a longer backset latch to become a feature of the door. The ability to separate the door knob and latch from the deadbolt and matching escutcheons allows for a variety of combinations to suit individual requirements.

### Features

- Internal spring mechanism ensures positive latch return
- Large bearing surface provides support for the solid knob
- Suitable for long back set tubular latches and mortise locks
- Reversible door knobs aid handing
- Machined from solid brass or bronze

## Fixing Centres and Latch/Lock Types

### 761, 762, 763, 767 Knobs on Mason 'A' Rose

#### Fixing Centres:

50.8mm @ 45 degrees, visible fixing on inside Rose

#### Lock/Latch Types:

- Tubular latches, 70mm backset or longer
- chant™ mortise lock, 70mm and 90mm backset with this lock, use Mason PM105, PM108 or chant™ escutcheons

### 762, 763, 764, 767 Knobs on chant™ 38F, 38R, 38S Roses

#### Fixing Centres:

38mm vertical and horizontal, concealed fixing both sides

#### Lock/Latch Types:

- Profile cylinder mortise locks with nominal 38mm centres, light return springs and appropriate backset
- chant™ mortise lock, 70mm and 90mm backset with this lock, use chant™ escutcheons
- Tubular latches - 70mm minimum backset recommended

### 762, 763, 764, 767 Knobs on chant™ 41F, 41R, 41S Roses

#### Fixing Centres:

41mm vertical and horizontal, concealed fixing both sides

#### Lock/Latch Types:

- chant™ mortise lock, 70mm and 90mm backset with this lock, use chant™ escutcheons
- Tubular latches - 70mm minimum backset recommended

#### Spindle size:

- Spindle supplied: 7.6mm or 8mm
- Suitable for full and split spindle applications



Round 763 on 44mm Plate  
 Diameter 55mm  
 Plate Width 44mm  
 Projection 63mm

Refer Technical Section to specify plate type within the following group:

Group  
 210

Example shown: A3-211 Plate

## Round/Royal Knobs on Plates

Refer to Technical Section for plate options.

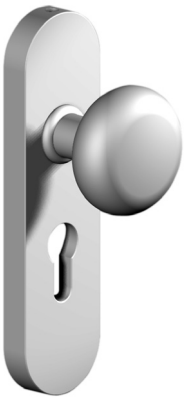

Round 763 on 44mm Plate  
 Diameter 55mm  
 Plate Width 44mm  
 Projection 63mm

Refer Technical Section to specify plate type within the following groups:

Groups  
 220, 230, 240, 250, 310

Example shown: A3-231 Plate



Royal 767 on 44mm Plate  
 Diameter 55mm  
 Plate Width 44mm  
 Projection 63mm

Refer Technical Section to specify plate type within the following groups:

Groups  
 210, 220, 230, 240, 250

Example shown: B4 250 Plate

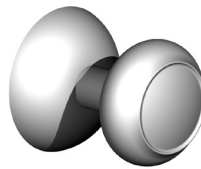

Royal 767 on Mason 'A' Rose  
 Door Knob  
 Knob Diameter 55mm  
 Rose Diameter 63mm  
 Projection 62mm

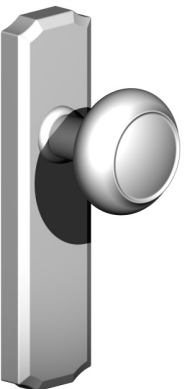

Royal 767 on 44mm Plate  
 Diameter 55mm  
 Plate Width 44mm  
 Projection 63mm

Example shown: C5 250 Plate

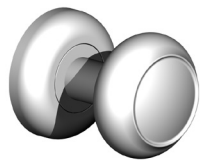

Royal 767 on chant™  
 38F, 38R, 41F, 41R Rose  
 Door Knob  
 Knob Diameter 55mm  
 Rose Diameter 57mm  
 Projection 62mm